

# CLASS 166, (3 CAR) DIESEL MULTIPLE UNIT

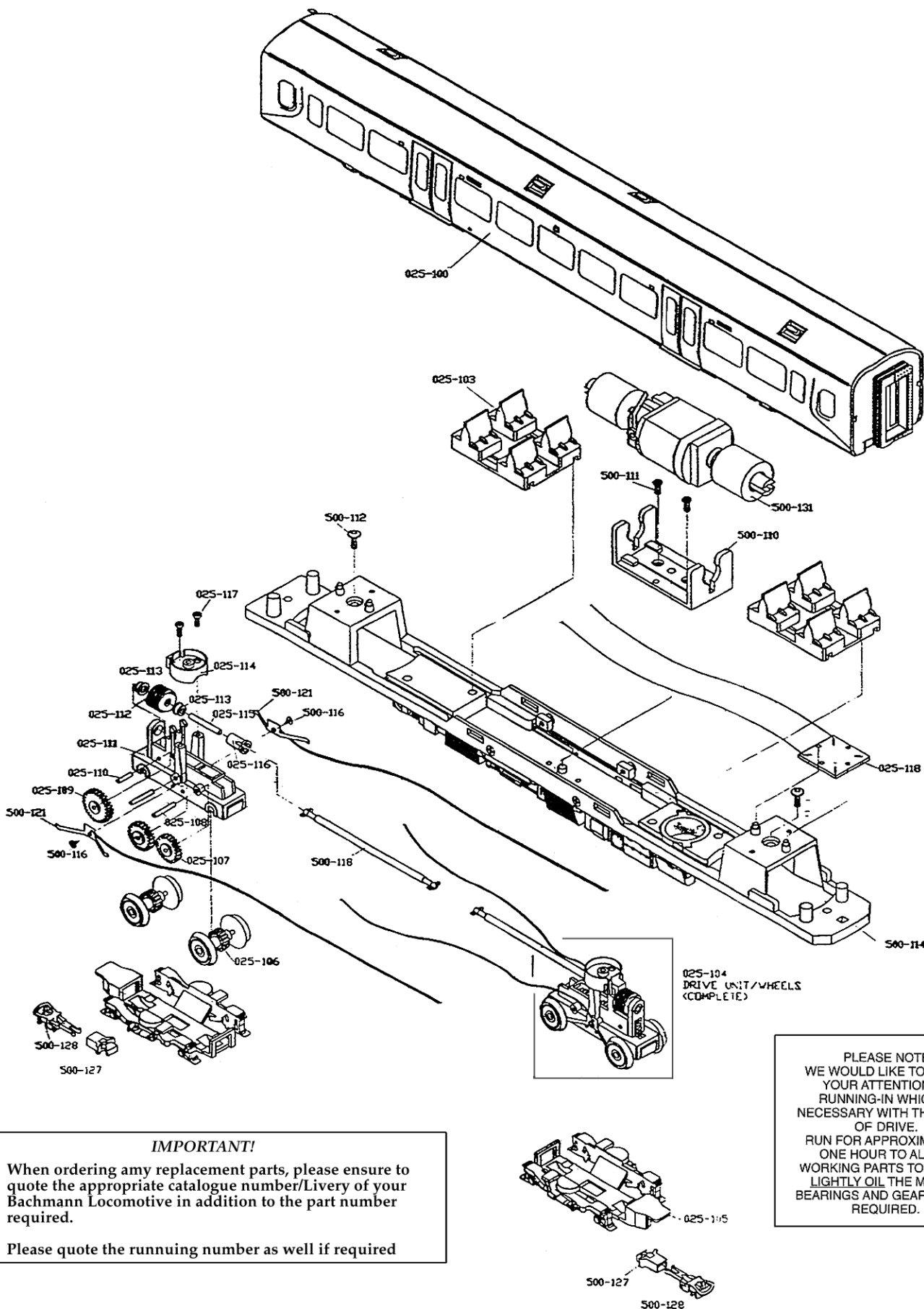

**IMPORTANT!**

When ordering any replacement parts, please ensure to quote the appropriate catalogue number/Livery of your Bachmann Locomotive in addition to the part number required.

Please quote the running number as well if required

PLEASE NOTE  
WE WOULD LIKE TO BRING  
YOUR ATTENTION TO  
RUNNING-IN WHICH IS  
NECESSARY WITH THIS TYPE  
OF DRIVE.  
RUN FOR APPROXIMATELY  
ONE HOUR TO ALLOW  
WORKING PARTS TO BED-IN.  
LIGHTLY OIL THE MOTOR  
BEARINGS AND GEARS WHEN  
REQUIRED.

